

How do I connect my robot cleaner to Roborock app on an Android device?

1. Download the Roborock from Google Play.

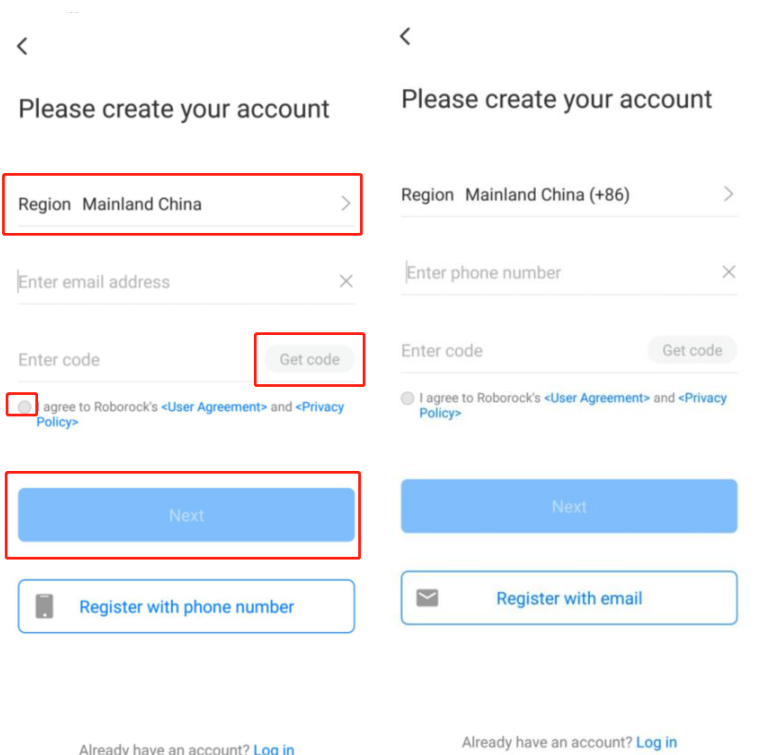

2. Select your current region and register for a Roborock account by your phone number or e-mail



3. Connect robot cleaner to Roborock app.

Notes:

- a. Make sure your phone is already connected to Wi-Fi;*
- b. Open the top of your cleaner to see the Wi-Fi indicator light during the connection process.*

3.1 Tap the “+” icon to add a device.

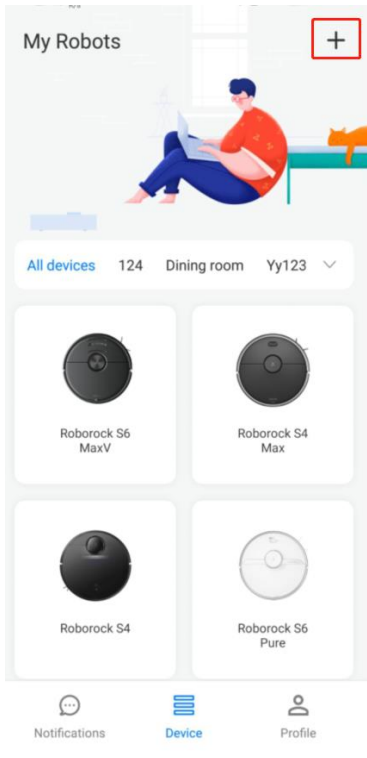

3.2 Detect nearby devices and add your robot cleaner.

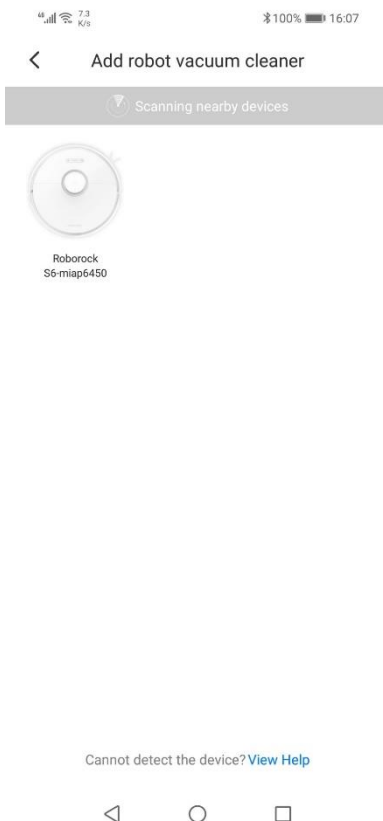

3.3 Select your home Wi-Fi and input your Wi-Fi password.

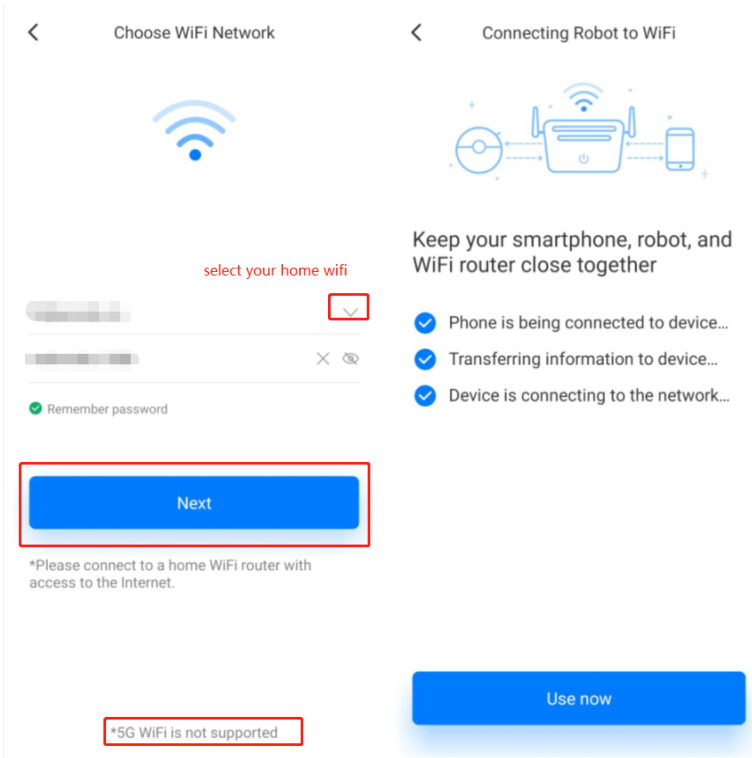

4. Tap the device in the Roborock homepage to Access device to operate it.